

Revision Notes

- 1 Original issue.
- 2 G1003 replaces G1001
- 3 D0005: Transfer not Timing

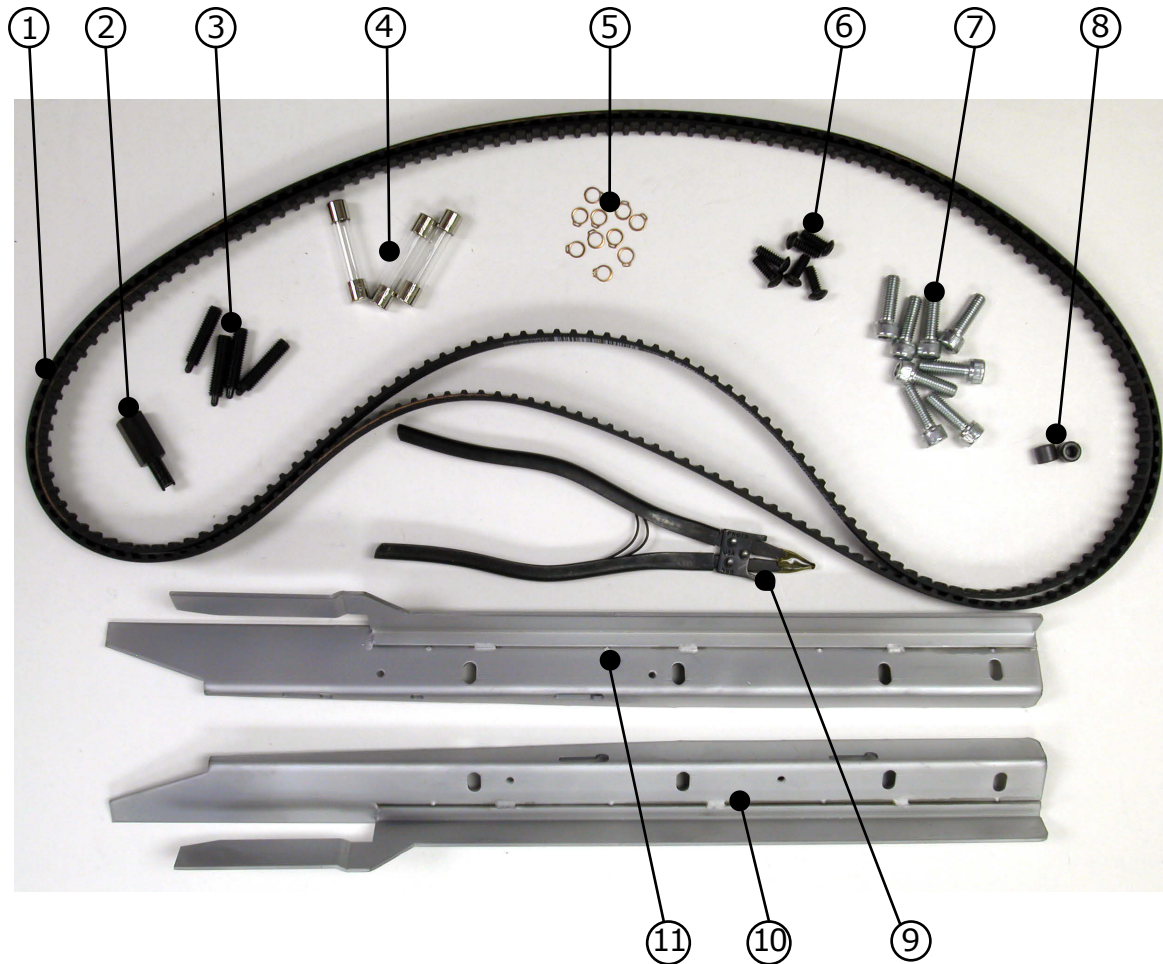

Item	Description	Qty	P/N
1	Transfer Belt	2	D0005
2	Wrench for Plunger	1	S6002
3	Spring Plunger, Heavy Force	4	S5003
4	Fuse, Slo-Blow	3	4300-0005
5	Retaining Ring	10	G1003
6	Allen Button Screw	6	SABAN0632037
7	Die Screw	8	SACAN1032062
8	Cam Follower Roller Sleeve	2	1006-2-3
9	Pliers	1	821-4-12
10	Track Feeder, Left	1	1008-4-3
11	Track Feeder, Right	1	1008-4-4

**GPD Global**

TOLERANCES UNLESS OTHERWISE SPECIFIED				NAME: CF-10 Spare Parts Kit, 120V	
FRACTIONS	1/32	METRIC		USED ON	CF-10 120V
2 PLACE DECIMAL	±0.015	0.0 MM	±0.4MM	MATERIAL	
3 PLACE DECIMAL	±0.005	0.00MM	±0.1MM	HEAT TREAT	-
ANGULARITY	±0.5°			FINISH	
RUNDOUT	±0.003 T.I.R.				
DRAWN BY: MK			DWG SIZE	PART NUMBER	REV
CHECKED BY:			DO NOT SCALE DRAWING	1010-1-100	3
DATE: 11/03/11			SCALE: N/A		